

Other related products

Converts electric charge output type sensors into voltage output type sensors (1pc → 1mV )

Charge converter  
**CC-20**

10 m/s<sup>2</sup> vibration tester which allows you to check accelerometers in the field.

Portable calibrator  
**CA-30**

Available in 4 selectable amplifier modules. Compact and expandable up to 64ch.

Data Recorder  
**LX-1000**

Featuring high-bandwidth, multi-channel and long recording time.

Wide-band data recorder  
**WX-9000 Series**



**TEAC CORPORATION**

1-47 Ochiai, Tama-shi, Tokyo 206-8530, Japan +81-42-356-9154

**TEAC AMERICA INC.** <https://datarecorder.jp/en/>  
10410 Pioneer Blvd., Unit #3, Santa Fe Springs, California 90670, U.S.A. +1-323-726-0303

**TEAC EUROPE GmbH.** <https://teac.eu/en/>  
Bahnstrasse 12, 65205 Wiesbaden-Erbenheim, Germany +49-(0)611-7158-362

**TEAC SALES & TRADING(Shenzhen) CO.,LTD.**  
Room 817, Xinian Center A, Tairan Nine Road West, Shennan Road, Futian District, Shenzhen, Guangdong Province, China +86-755-8831-1561

Copyright© 2025 TEAC CORPORATION. All rights reserved.

Other company names and product names in this document are the trademarks or registered trademarks of their respective owners.  
Features and specifications are subject to change without notice.  
Precaution : To ensure safe handling and operation, read the Instruction Manual before use.

PRINTED IN JAPAN 0825 ·ISD-045E-A4

# TEAC

## Piezoelectric type accelerometer & Related products digest catalog

<https://datarecorder.jp/en/>



TEDS	Built-in Pre-amplifier
Tiny & Lightweight	Comes with a 3.3m special cable
3 Axes	Waterproof (730ZW)

730ZT / 731ZT / 730ZW (Waterproof) is a 3-axis accelerometer with a built-in pre-amplifier which is 10 cubic millimeter in size and 4.4g in weight. Its high frequency response and tiny super-lightweight feature allow to measure acceleration on small objects. It is also appropriate for various tests on engines because of its high operational temperature.

3 models available to best suit your application

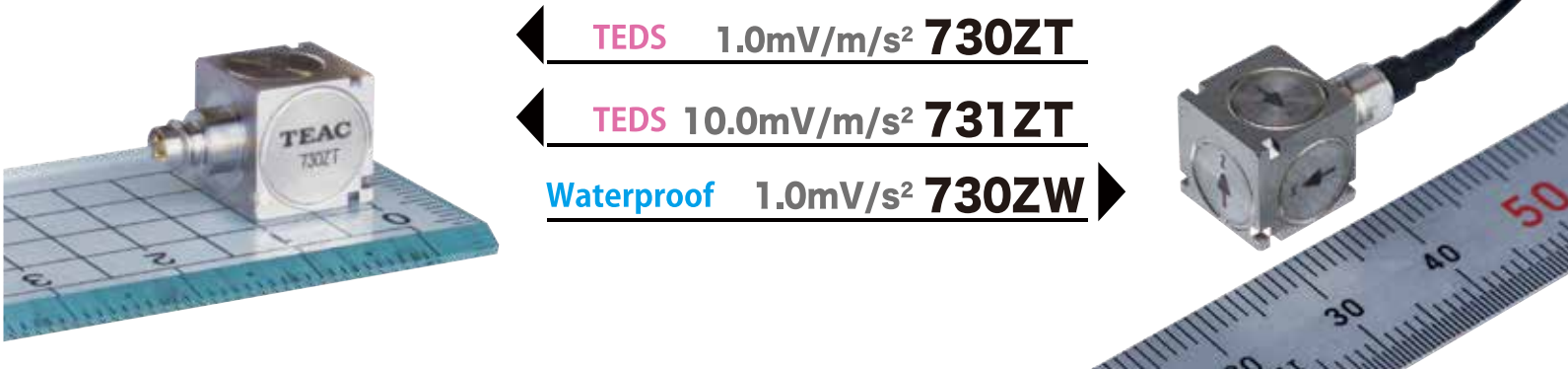

TEDS	1.0mV/m/s <sup>2</sup>	<b>730ZT</b>
TEDS	10.0mV/m/s <sup>2</sup>	<b>731ZT</b>
Waterproof	1.0mV/s <sup>2</sup>	<b>730ZW</b>



3-axis tiny piezoelectric type accelerometer

730ZT/731ZT/730ZW



Spec

Model	730ZT	730ZW	731ZT
	Standard type	Waterproof type	High sensitivity type
Sensitivity (mV/m/s <sup>2</sup> )	1.0 ± 10 % (9.8 mV/g)		10.0 ± 10 % (98 mV/g)
Transverse sensitivity (max)	Less than 5 %		Less than 5 %
Base noise (max)	20 μVrms		40 μVrms
Compensated temperature range	-50 °C ~ 120 °C		-50 °C ~ 110 °C
Frequency response (±3dB)	X, Y axis : 0.5 Hz ~ 15,000 Hz Z axis : 0.5 Hz ~ 20,000 Hz		X, Y axis : 0.5 Hz ~ 10,000 Hz Z axis : 0.5 Hz ~ 18,000 Hz
Resonance Frequency	55 kHz or higher (Z axis)		55 kHz or higher (Z axis)
Max. acceleration (m/s <sup>2</sup> )	±5000 (±510g)		±450 (±46g)
Max. tolerated acceleration (m/s <sup>2</sup> )	30,000(3,060g) or higher		30,000(3,060g) or higher
Output impedance	Less than 100 Ω		Less than 500 Ω
Ground	Case ground		Case ground
Cable	Proprietary cable CL-730B (3.3m, 4P-BNC)	3.3m (installed-BNC×3)	Proprietary cable CL-730B (3.3m, 4P-BNC)
Connector	CZ710	-	CZ710
Case material	Titanium		
Size (W x H x D)	10 mm x 10 mm x 10 mm (Connector excluded)		
Weight	approx. 4.4 g	approx. 4.9 g (Cable excluded)	approx. 4.4 g
Included	Mount base x1	Mount base x1	Mount base x1
	Mounting screw (M3 x 0.5 x 4) x1 CL-730B (3.3m, 4P-BNC)	Mounting screw (M3 x 0.5 x 4) x1	Mounting screw (M3 x 0.5 x 4) x1 CL-730B (3.3m, 4P-BNC)

Optional accessories

Cable	For 730ZT / 731ZT ( 3.3m, 4P-Miniature )	CL-730M
	For 730ZT / 731ZT ( 3.3m, 4P-BNC )	CL-730B
Mount base	For 730ZT / 731ZT 5 pcs included	PS-730Z
Magnet mount	For 730ZT / 731ZT	MG-730Z



Cable ( 3.3m, 4P-Miniature ) CL-730M



Cable ( 3.3m, 4P-BNC ) CL-730B

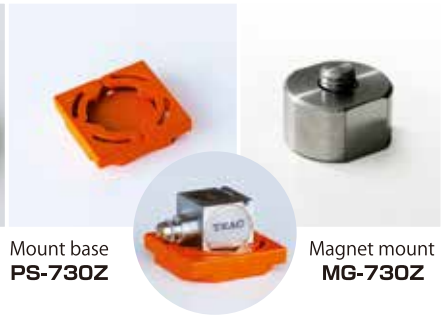

Mount base PS-730Z

Magnet mount MG-730Z

Dimensions

730ZT / 731ZT Common

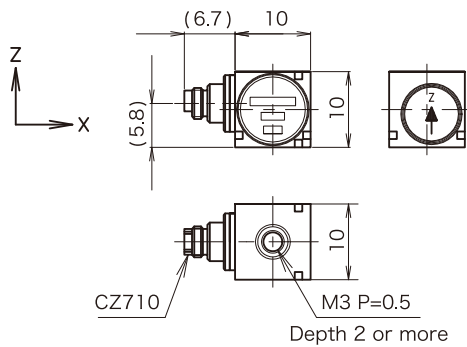

730ZW

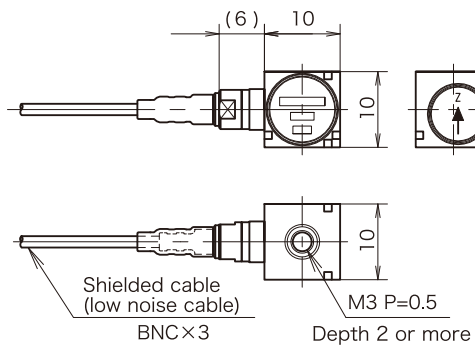

730ZW

Electric charge type

Tiny accelerometer series

611・611W

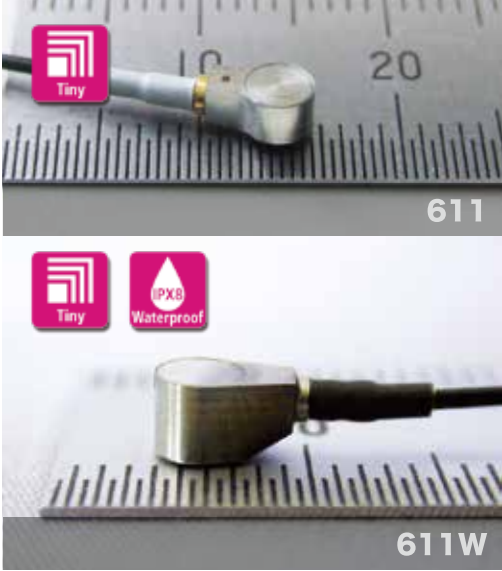

Model	611	611W
Feature	Super small	Super small Waterproof
Max. Acceleration (m/s <sup>2</sup> )	±100,000 (±10,197g)	±10,000 (±1,020g)
Sensitivity (pC/m/s <sup>2</sup> )	0.035 (0.34 pC/g)	0.0459 (0.45 pC/g)
Frequency response (Hz) ±3dB	fc~20,000	fc~20,000
Compensated temperature range (°C)	-50~160	-50~160
Cable	3m (installed)	3m (installed)
Weight (g)	approx. 0.2	approx. 0.2
Waterproof rank	-	IPX8

※611W : BUILD TO ORDER

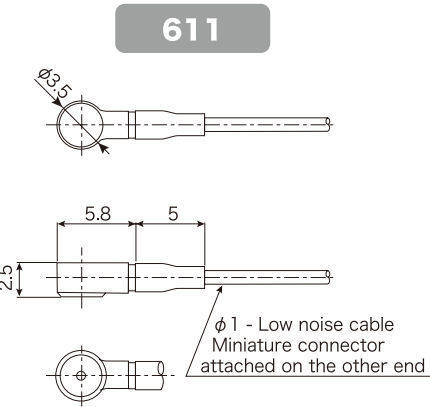

611ZS・611ZSW



Model	611ZS	611ZSW
Feature	Super small	Super small Waterproof
Max. Acceleration (m/s <sup>2</sup> )	±25,000 (±2,550g)	±25,000 (±2,550g)
Sensitivity (pC/m/s <sup>2</sup> )	0.04 (0.39 pC/g)	0.04 (0.39 pC/g)
Frequency response (Hz) ±3dB	fc~20,000	fc~20,000
Compensated temperature range (°C)	-50~160	-50~160
Cable	3m (installed)	3m (installed)
Weight (g)	approx. 1.2	approx. 1.3
Waterproof rank	-	IPX8

※611ZSW : BUILD TO ORDER

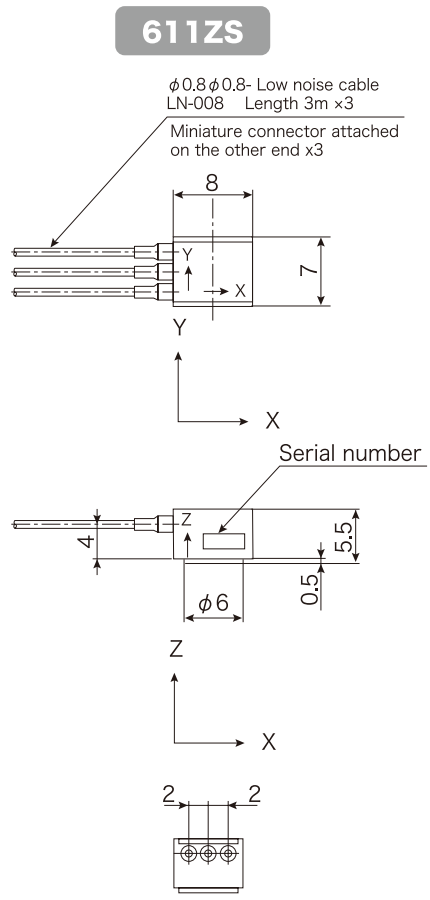

612

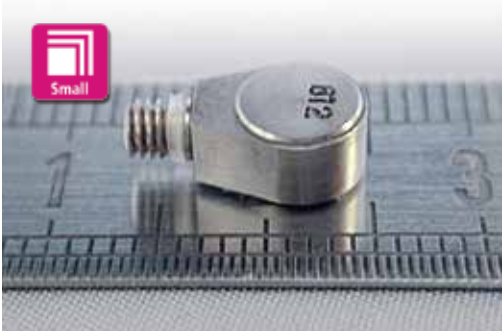

Model	612
Feature	Small
Max. Acceleration (m/s <sup>2</sup> )	±10,000 (±1,020g)
Sensitivity (pC/m/s <sup>2</sup> )	0.17 (1.68 pC/g)
Frequency response(Hz) ±3dB	fc~18,000
Compensated temperature range	-50~160 (°C)
Weight (g)	0.8

